

ATTACHMENT C

ATTACHMENT C

DESIGN REPORT



Sydney2030/Green/Global/Connected



Wimbo Park

Landscape Design Concept

Attachment C - Design Report

February 2017

concept plan

Wimbo Park sits at the eastern end of Devonshire Street in Surry Hills, at the doorstep of the inner city and the parklands of Centennial and Moore Parks. It is also the new alignment of Sydney's South-East Light Rail, which connects Circular Quay to Randwick, making a new park and potential light rail stop on the Olivia Gardens site. Transport for NSW will deliver the Light Rail Infrastructure and a pedestrian and bicycle shareway that crosses the park from Bourke to South Dowling Streets, the City of Sydney delivering this new community park.

The park design places an urban edge to Bourke and Devonshire Streets with the parkland open space figured towards Centennial Park. A cycleway and pedestrian path running in parallel with the light rail line and separating the main body of the park from this movement corridor. Making an open space for local residents and the children of Bourke Street Public School, as well as a performative landscape with a living urban ecology.

concept plan- temporary langton centre parking

- ① textured paving to reduce cyclists speed in seating square
- ② Parkham Lane shareway
- ③ faceted edge between shareway and seating square
- ④ BBQ
- ⑤ bike racks- CoS standard
- ⑥ long dining table in palm grove
- ⑦ terraced steps for outdoor classes
- ⑧ trampoline play area
- ⑨ elevated seating node
- ⑩ open lawn with seating wall
- ⑪ Parkham Place link
- boardwalk over rain garden
- steps to Nobbs Lane
- ⑫ rain garden
- balancing wall & sunken forest
- ⑬ elevated walkway to retain fig tree
- ⑭ existing trees retained
- existing kerb line retained
- ⑮ path connection to parking
- ⑯ existing substation
- Wimbo Paddock mosaic to facade
- ⑰ stone masons monument

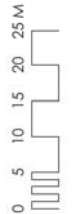

park rain garden area- 120m²

concept plan- long term masterplan

- ① textured paving to reduce cyclists speed in seating square
- ② Parkham Place share way
- ③ faceted edge between shareway and bourke st square
- ④ BBQ
- ⑤ bike racks
- ⑥ long dining table in palm grove
- ⑦ terraced steps for outdoor classes
- ⑧ trampoline play area
- ⑨ elevated seating node
- ⑩ open lawn with seating wall
- ⑪ western rail link
- boardwalk over rain garden
- steps to Nobbs Lane
- ⑫ rain garden
- balancing wall & sunken forest
- ⑬ graded share path to south dowing st
- ⑭ nobbs lane rain garden
- broken kerb
- ⑮ garden seating nook
- ⑯ existing substation
- Wimbo Paddock mosaic to facade
- ⑰ stone masons memorial
- ⑱ new corner blister to nobbs lane



park rain garden area- 120m²

nobbs lane rain garden area- 110m²

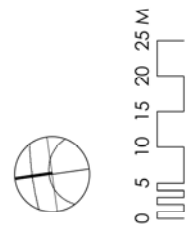



Bourke Street Seating Square

The design for Wimbo Park can be understood in four parts:

- > An urban terrace & threshold at Bourke Street
The terrace gives a sense of conclusion to Devonshire Street, integrates the light rail crossing and an extension to Parkham Lane, while making two gathering spaces. To the north of the light rail a long table and two barbeques make a place for lunching and community events, while the larger space to the south is defined by a folding ground plane which separates people from exiting vehicles. Here stools are dotted along the perimeter of this undulate edge allowing both small groups and individuals to gather comfortably. Large circular seats ringing two Sydney Red Gums nearby. The pattern of elements giving this part of the site a beautiful drifting quality, which recalls the original landscape of the Botany Sands and connects this site geologically to Centennial Parklands.

Bounding the southern edge of the park the electricity substation will have its dark brick face transformed with the colourful mosaic 'Wimbo Paddock Mural', that depicts the real and imagined life of the park.

- > The shareway & central park
The shareway is set level with the Light Rail and gently grades from the terrace to South Dowling Street. It is five metres wide with a wavering edge that holds lights, seats, planting and a shifting line of Scribbly Gums that give filtered shade along this route. Part way along the path a more generous breakout space is situated where people can rest and wait for friends.
The park itself is set down 450mm from the shareway, making a subtle change in level which helps keep small children away from the bustle of the shareway and at the same time, forms a lower seating edge for families and carers. Where the park meets Parkham Lane the ground folds up to form a grassy bank for sunning and playing, with the external face of the berm planted to control movement, while screening garage doors and passing traffic.

At the western end of the park long steps make a formal entry to the lawn and a place for gathering. Close by a trio of inground trampolines invite local kids to play. The shifting width of the grass gives a sensuous feel to this long lawn and allows for many people to use the space. At the opposite end the lawn folds down and forms a soak or rain garden that captures and treats stormwater from the park and laneway. A boardwalk allows access from the lane to the shareway, while the perimeter seat traverses this wider corner of the park, making a balancing beam for children to move through this spongy landscape-like the tight rope walker, Blondin, who is said to have scaled aerial wires at Wimbo Paddock in the early twentieth century. A 'grave' of gnarly bleached tree trunks giving a sense of intensity and mood to this corner of the park- onlookers to this past spectacle.

- > The threshold to South Dowling Street
As the eastern end of the shareway rises to meet South Dowling Street, a copse of fast growing Scribbly Gums and Sydney Red Gums will replace the old Morton Bay Fig removed as part of the Light Rail construction. Bringing back an abstracted representation of the Eastern Suburbs Banksia Scrub originally at home on these dunal soils, while shading a series of zig zag seats at the threshold to Moore Park.

- > The landscaped edge to Nobbs Lane
As part of Light Rail project, parking displaced from the Langton Centre will be sited temporarily along Nobbs Lane. The configuration of parking bays aligned to protect the large plane trees on this kerb. A slip path from Olivia Lane allows access into Wimbo Park, while the perimeter of the rail line is planted with local species and discretely fenced. At the junction of the laneway path and visible from the communal table, is sited the sandstone fountain that currently resides in the park. Finding a new home at this local entry and gathering space.

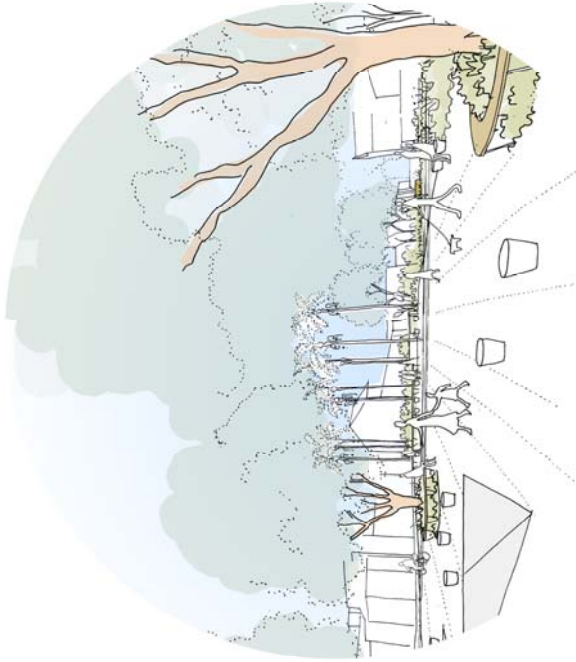

Bourke Street Seating Square

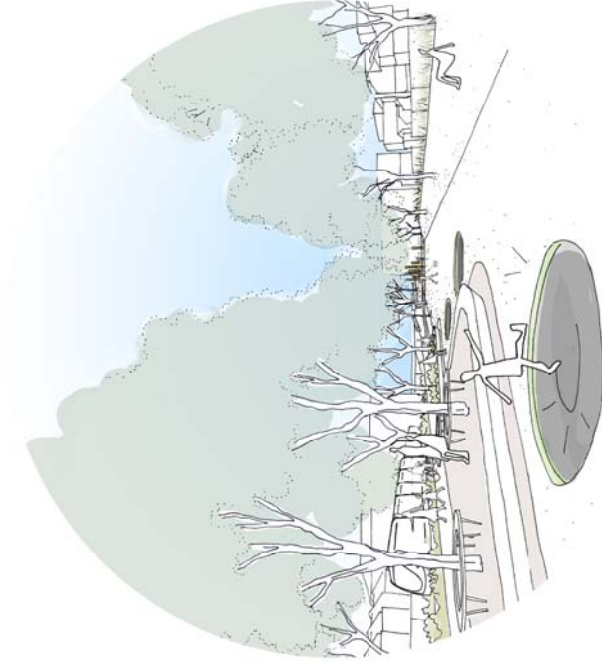

Trampoline Play & Open Lawn

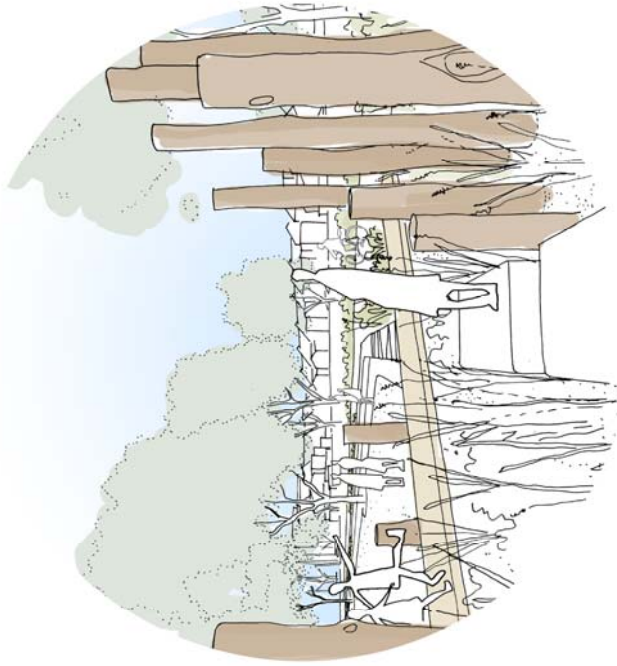

Raingarden with sculptural play



Trampoline Play & share path

section AA- west

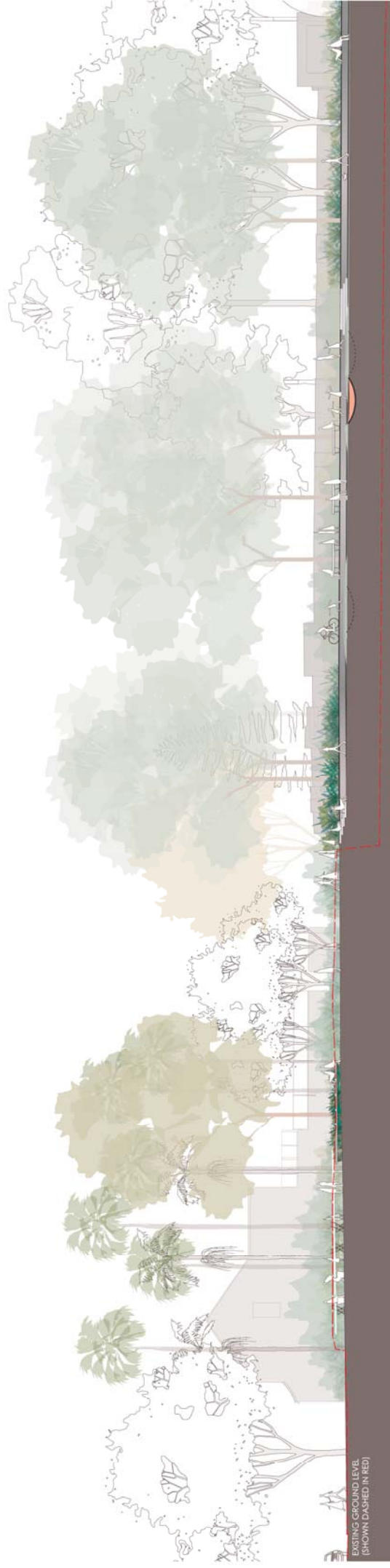

EXISTING GROUND LEVEL
(SHOWN DASHED IN RED)

BOURKE STREET
EDGE

SEATING SQUARE

TERRACE STEPS

TRAMPOLINE PLAY AREA
& ELEVATED SEATING NODE



section AA- east

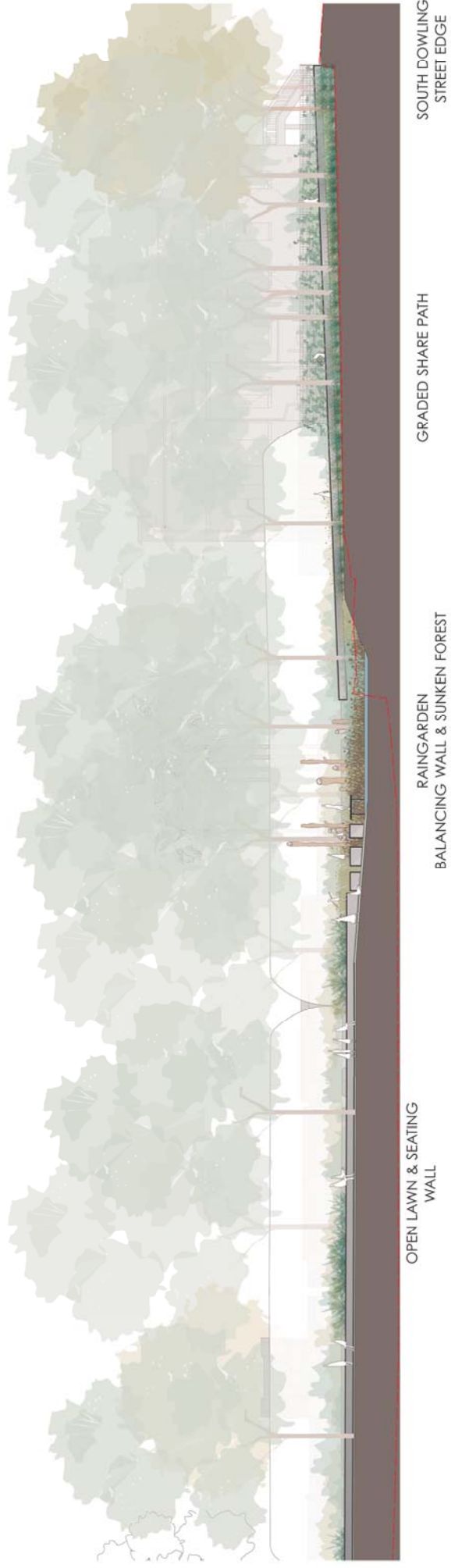

Bourke Street seating square- precedents



The Goods Line, Ultimo
Aspect Studios



tilted planes with contrasting paving to define road
through seating square
Train station Square, Padova



Israel Square, Copenhagen,
Sweco



Feyssine Park, Lyon
Iles Paysage Urbanisme



The Bouncing Dome,
Showa Kinen Koen

rain garden- precedents



sculptural play



Forest Gallery
Melbourne Museum
TLC



Gohard Brook, Nantes,
Atelier des paysages Bruei-Delmar



Shenyang Architectural University Campus